



Nurtured in Nature



Pre-Certified
Silver Rating by
Indian Green
Building Council (IGBC)





POOL TABLE
BADMINTON
COURTS
GYMNASIUM
SWIMMING
POOL

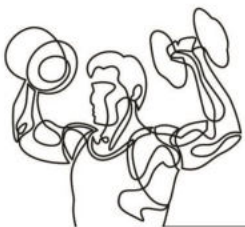

AMENITIES*

- Cafeteria
- Swimming Pool & Baby Pool with Sundeck & Changing Room
- Hobby Room
- Modern Multi Gym
- AC Banquet Hall with Kitchen
- Indoor Games Room
- Badminton Courts
- Children's Creche
- Party Lawn / Landscaped Garden
- Multi-purpose Hall
- Squash Court



*All the amenities described above will be available on completion of Phase - IIA & Phase - IIB.

LIVE GREEN

- Sewage Treatment Plant
- Rain Water Harvesting System
- Fitness Garden
- Central Lawn
- Use of Recycled Materials / Ecofriendly material such as Fly Ash Brick ect.
- High Window guaranteeing Better Views and Cross Ventilation

LIVE SMART

- Intercom
- Water Filtration Plant
- 24 Hours Power Back up for common areas
- 24 Hours Power Back up for flat (at extra cost)
- 24 Hours Water Supply
- Security with 24 Hrs Surveillance (CCTV Camera)
- Grand Entrance Gate





The name says it all.

Perfectly located, conveniently connected, embraced by nature, **picturesque views...**
A perfect urban life you always dreamed of. More than 7 Acres of well planned
Mega Residential Complex (About 800 Apartments*) / G + 10
Storeyed Residential Towers. About 50% open area with Ultra Modern Amenities.

* On completion of all the Phases i.e Phase - I, Phase - IIA & Phase - IIB



Quality without compromise

Designed by leading architects, Urban Greens is meticulously planned to maximize space, comfort and style. The best of materials and fittings have gone into building your new home. The walls, doors and floors breathe elegance. Kitchens and bathrooms are fitted with best-in-class fixtures. You will be proud of it.

Interiors

Internal walls - Smooth, impervious plaster of Paris or wall putty

Doors - Doors with tough timber frames and solid-core plush shutters

Flooring - Vitrified tiled flooring in all bedrooms, living/dining rooms

Windows - Aluminum frames with fully glazed shutters and fittings

Kitchen

Flooring - Ceramic tiles

Counter Tops - Granite with steel sink, aluminum frames with fully glazed shutters and fittings

Dados - Ceramic tiles up to a height of 2 ft from the granite counter top

Bathrooms

Flooring - Ceramic tiles

Dados - Ceramic tiles up to a height of 7ft

Sanitary ware

White, porcelain textures and chromium-plated fittings, commode with concealed cistern

Electricals

Good quality concealed copper wiring with the latest modular switches and miniature circuit breakers, provision for TV sockets, cable TV and broadband connections.

Exteriors

Weatherproof, non-fading exterior finish of the best quality





URBAN GREEN (PHASE I)



Client Testimonials URBAN GREENS (PHASE I)



Urban Greens has given us enough warmth so that we could make our first property our first HOME!!!

Soumyajit Srimani and Purba Srimani



"We are extremely happy to have an apartment at Urban Greens, an elegant and charming Oasis in Rajarhat. A Blissful Living with happiness in a sophisticated apartment.

Mehul Jaiswal & Priyanka Jaiswal



"Urban Greens" The name itself describes the apartment. People living here are very helpful and that makes a healthy environment. Construction quality is good, Maintenance staffs are prompt and management is easy to reach. Overall a beautiful apartment and perfect place to live.

Kailash Agarwal & Payel Agarwal



Great urban living experience in Urban Greens with nice neighbours. Thanks to Loharuka Group to create this awesome ambience with beautifully designed apartments and all amenities you need for today's modern living. Urban Greens is in close proximity of Biswa Bangla corridor Chinara Park Stop (500m), City Centre 2 and near-completion Airport-Garia Metro project.

Debiprasad Halder & Munmun Mallick Halder



Display Vinimay Private Limited. is the promoter / developer of Urban Greens Housing Complex and is an associate concern of the LOHARUKA GROUP. Loharuka Group is engaged in real-estate development for more than 25 years and has a proven track record of development of residential projects and customer satisfaction. The Loharuka Group through its group companies / sister concerns / associates is engaged in providing homes to the endless families, who aspire for their dream home becoming a reality, along with modern lifestyle amenities under the brand LOHARUKA. The group has completed several landmark projects in Kolkata and Pune, and is currently lined up with significant projects in Kolkata and Pune.



Green Heights (Rajarhat, Kolkata)



Urban Greens (Rajarhat, Kolkata | Phase I)



Freshia (Rajarhat, Kolkata)



Green Oasis (Rajarhat, Kolkata)



Green Chinari (Rajarhat, Kolkata)



Green Vista (Rajarhat, Kolkata)

URBAN GREENS

Phase - IIA →

URBAN GREENS

← Phase - IIB

URBAN GREENS

Phase - I
Completed

← Future
Development

Overall Typical Floor Plan

Phase - IIA

- Badminton Court ①
- Mini Party Lawn ④
- Shaded Cove ⑩
- Stepped Amphi Court ⑪
- Drop Off ⑭
- Barbecue Corner ⑯
- MLCP ⑱
- Car Parking ⑲
- Multipurpose Court ⑳
- Party Lawn ㉑
- Landscape Garden ㉓

Phase - IIB

- Badminton Court ①
- Kids' Play Area ③
- Mini Party Lawn ④
- Swimming Pool ⑤
- Kids' Pool ⑥
- Deck ⑦
- Covered Sit-out ⑧
- Fitness Garden ⑨
- Landscape Garden ㉓
- Future Development ㉒

Phase - I

- Badminton Court ①
- Kids' Play Area ③
- Fitness Garden ⑨
- Drop Off ⑭
- Barbecue Corner ⑯
- Car Parking ⑲
- Guard House ②
- Entrance Garden ⑬
- Biodiversity Trail ⑫
- Water Feature ⑮
- Garden Pathway ⑰

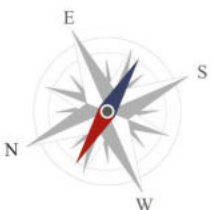

Block 5 | Typical floor plan

TYPE	CARPET AREA	BALCONY AREA	BUILT-UP AREA
A	673	35	783
B	897	46	1017
C	908	37	1027
D	670	25	763
E	679	25	775
F	839	35	948
G	830	43	945
H	674	34	785

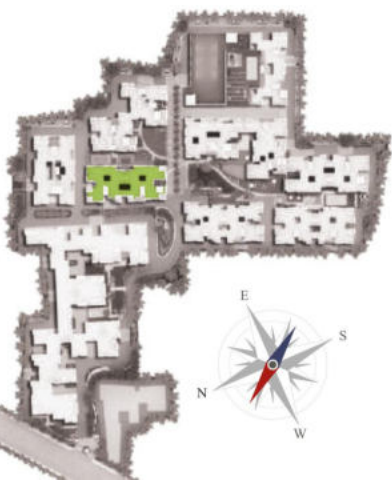

Dimensions mentioned are tentative, physical may vary.

Block 6 | Typical floor plan

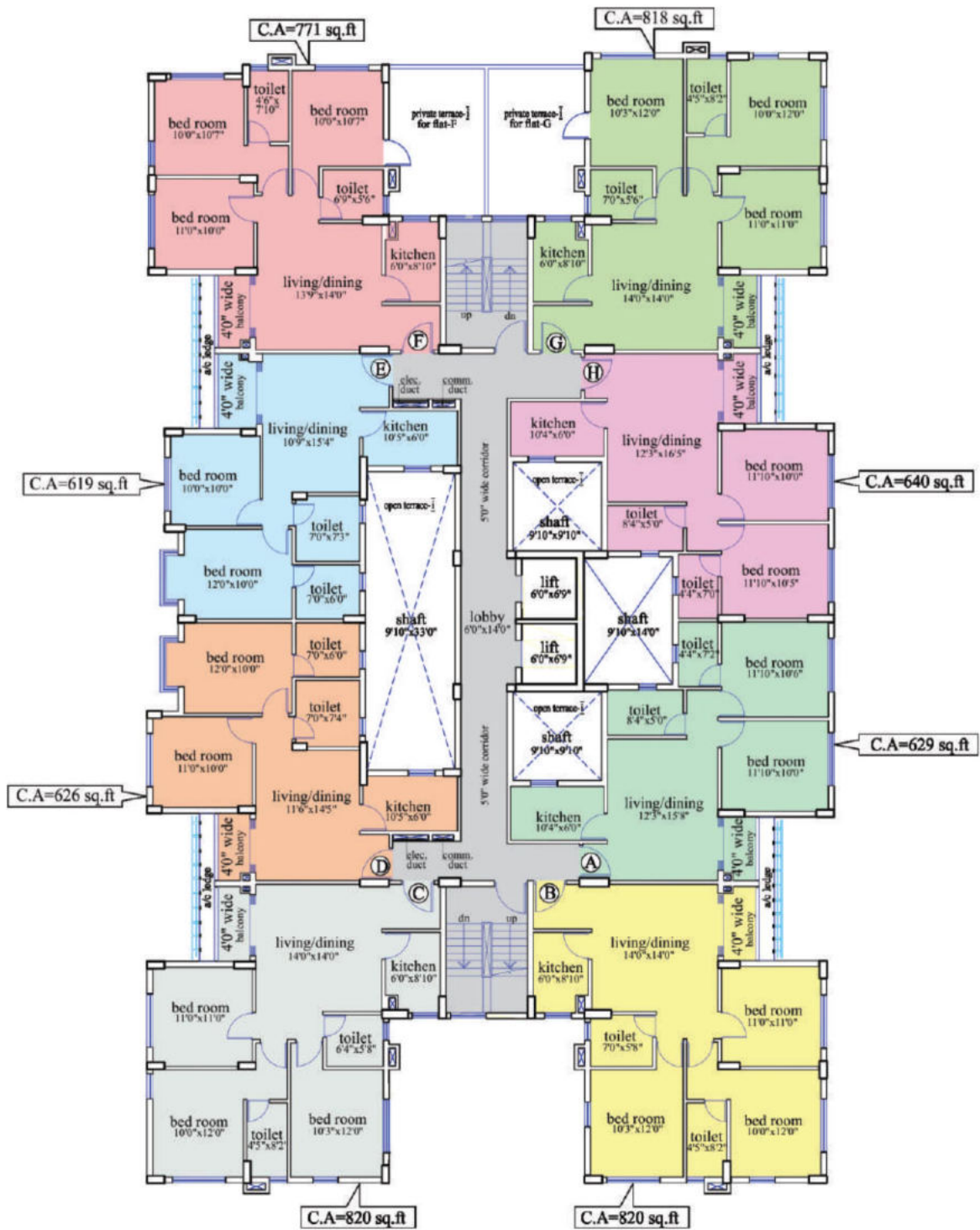

TYPE	CARPET AREA	BALCONY AREA	BUILT-UP AREA
A	629	25	718
B	820	29	923
C	820	29	923
D	626	26	713
E	619	29	707
F	771	28	871
G	818	30	921
H	640	28	733

Dimensions mentioned are tentative, physical may vary.

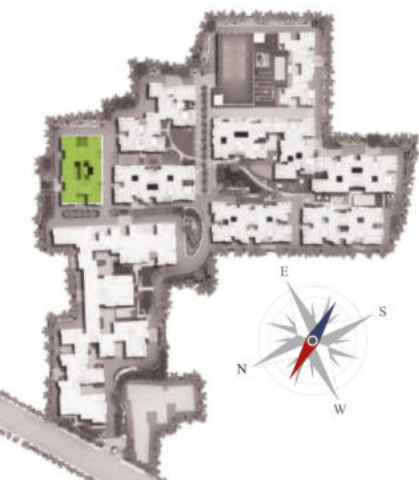

Block 7 & 8 | Typical floor plan

TYPE	CARPET AREA	BALCONY AREA	BUILT-UP AREA
A	723	28	825
B	933	36	1056
C	997	37	1118
D	646	33	749

Block 8

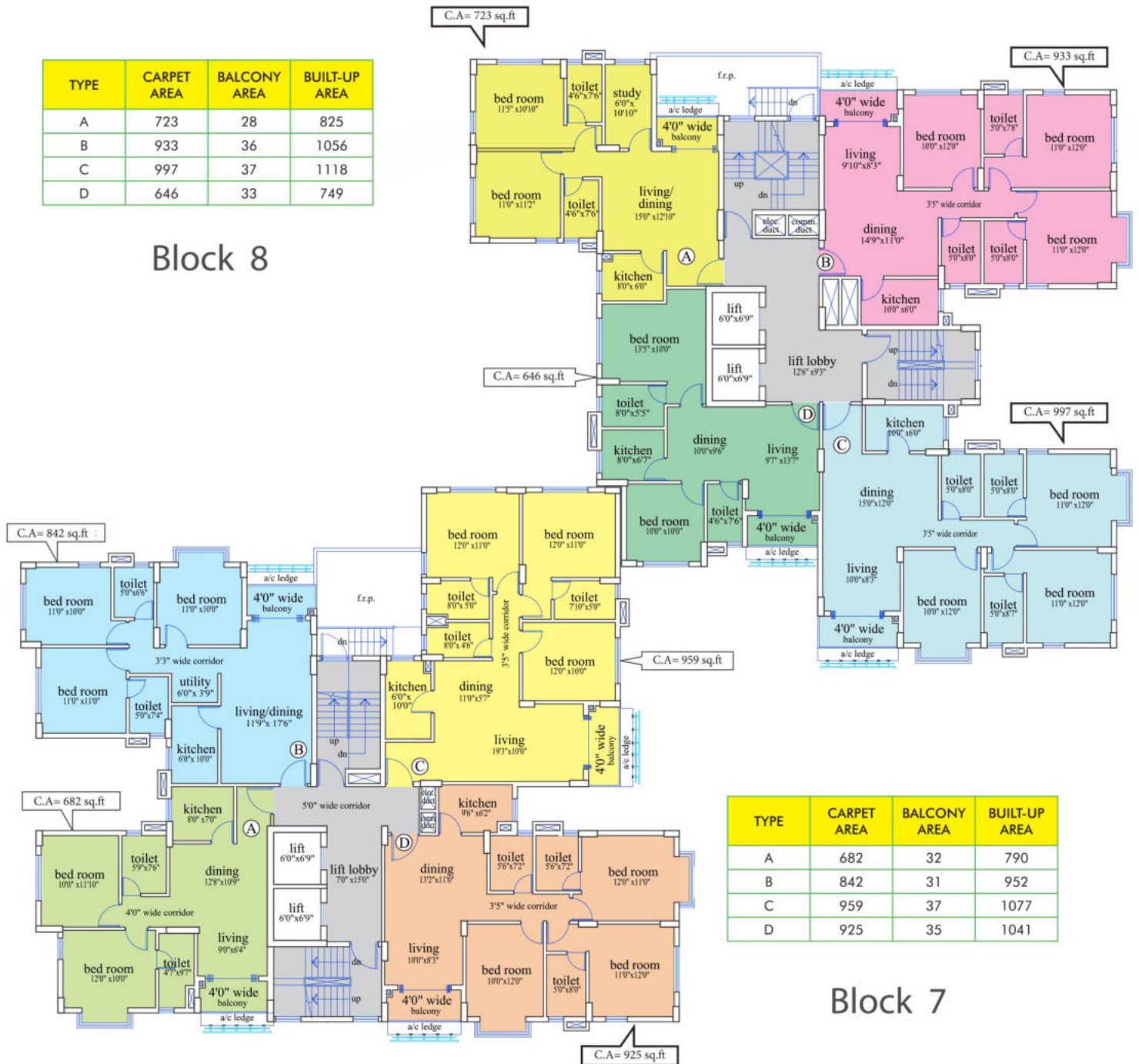

TYPE	CARPET AREA	BALCONY AREA	BUILT-UP AREA
A	682	32	790
B	842	31	952
C	959	37	1077
D	925	35	1041

Block 7



Dimensions mentioned are tentative, physical may vary.

Block 9 | Typical floor plan

TYPE	CARPET AREA	BALCONY AREA	BUILT-UP AREA
A	588	33	707
B	841	27	946
C	642	20	726
D	642	20	726
E	841	27	946
F	588	33	707



Dimensions mentioned are tentative, physical may vary.

Block 11 | Typical floor plan

TYPE	CARPET AREA	BALCONY AREA	BUILT-UP AREA
A	801	43	927
B	853	61	990
C	608	32	701
D	763	35	863
E	917	37	1040
F	604	34	722

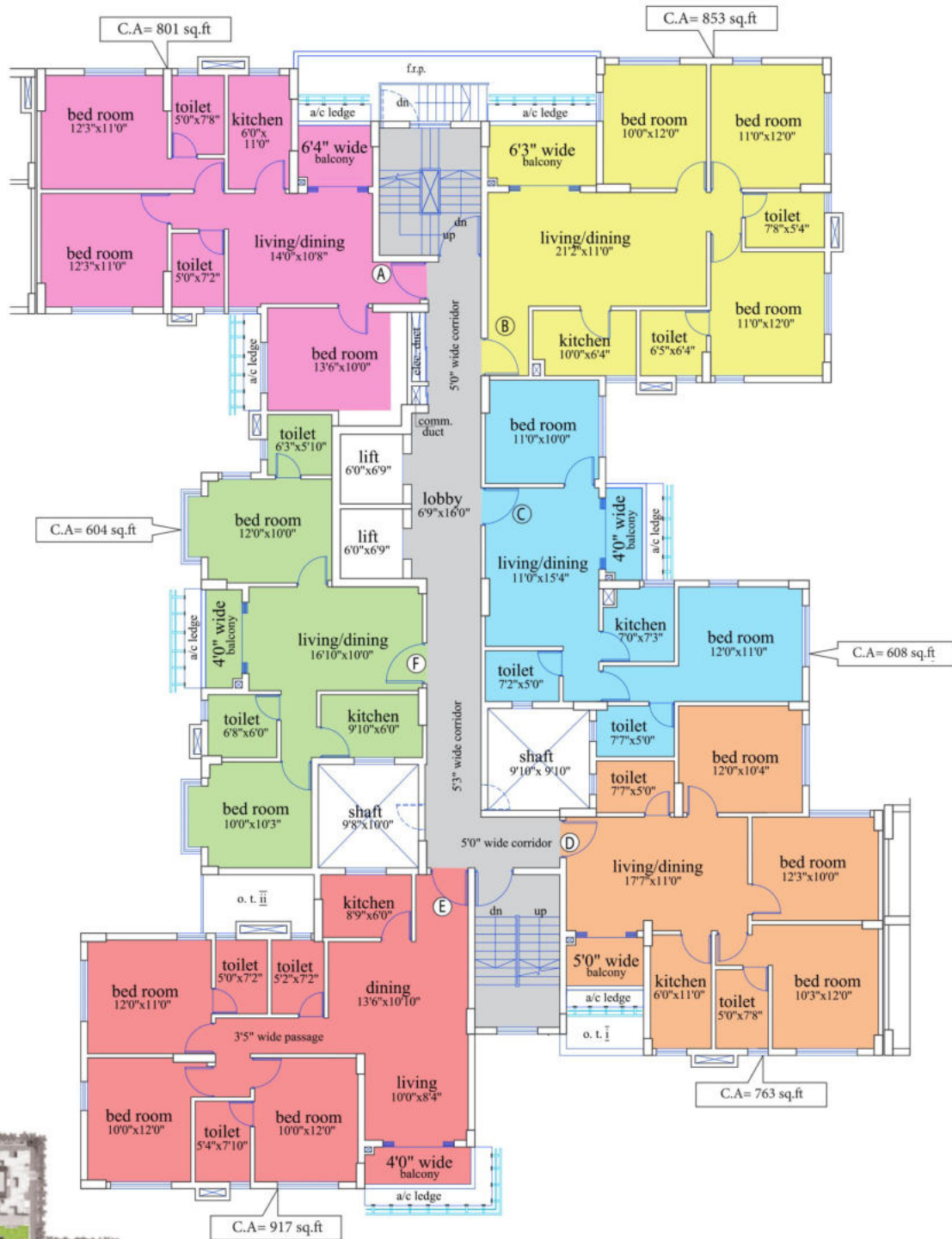

Dimensions mentioned are tentative, physical may vary.

Block 12 | Typical floor plan

TYPE	CARPET AREA	BALCONY AREA	BUILT-UP AREA
A	679	36	789
B	913	42	1033
C	790	45	907
D	674	24	768
E	669	24	768
F	883	39	997
G	880	44	995
H	677	35	789

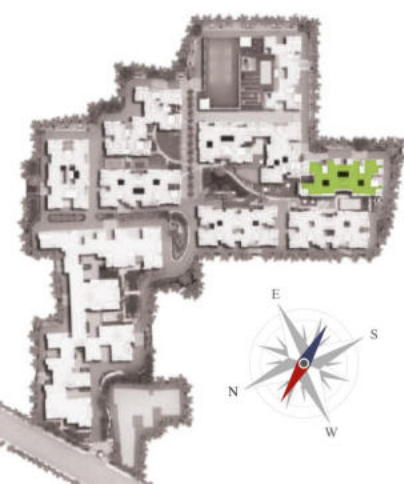
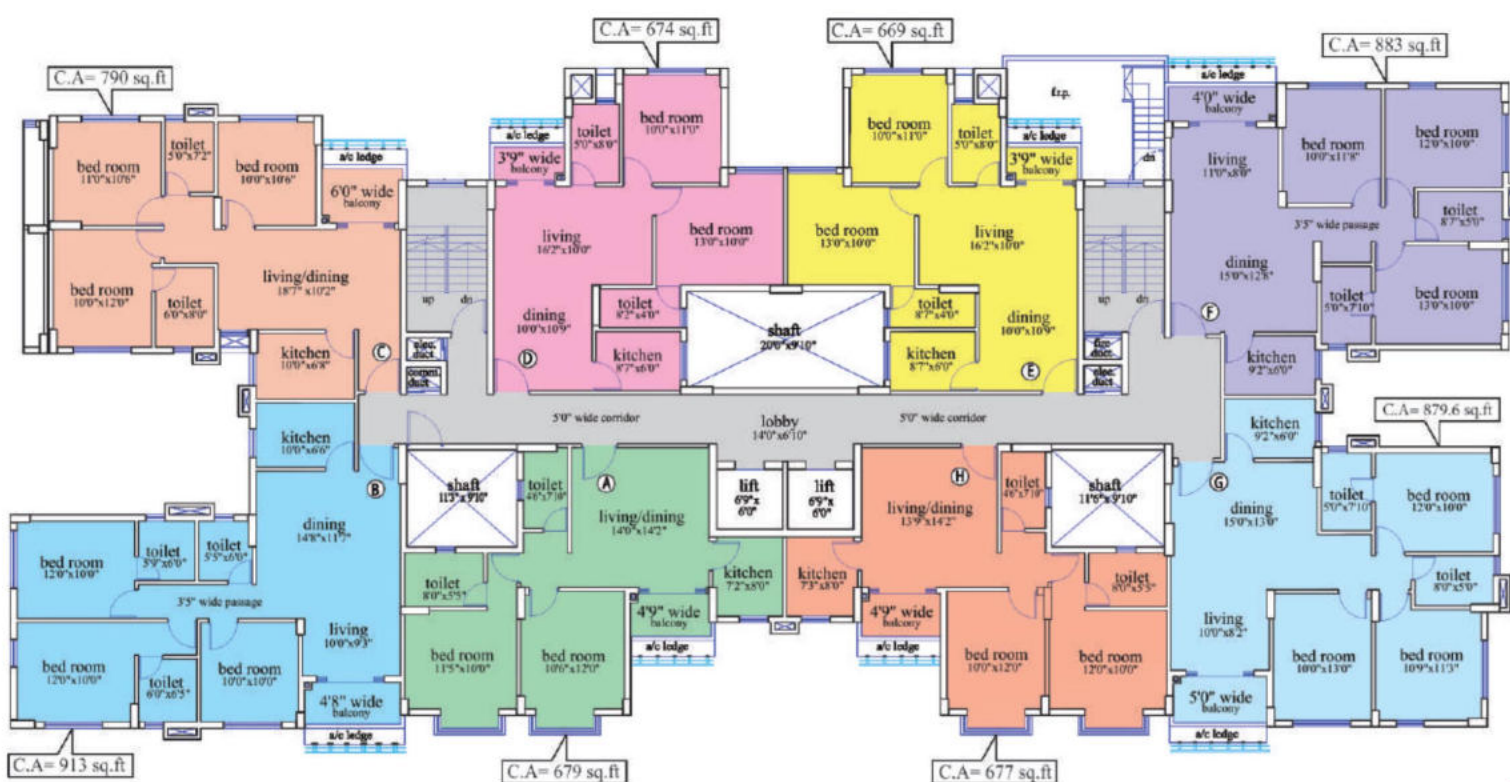

Dimensions mentioned are tentative, physical may vary.

Block 13 | Typical floor plan

TYPE	CARPET AREA	BALCONY AREA	BUILDING AREA
A	679	37	793
B	887	34	990
C	881	35	993
D	665	24	757
E	665	24	758
F	896	35	1008
G	908	34	1012
H	677	36	790

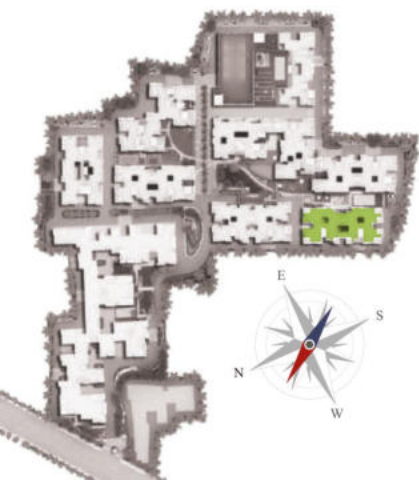
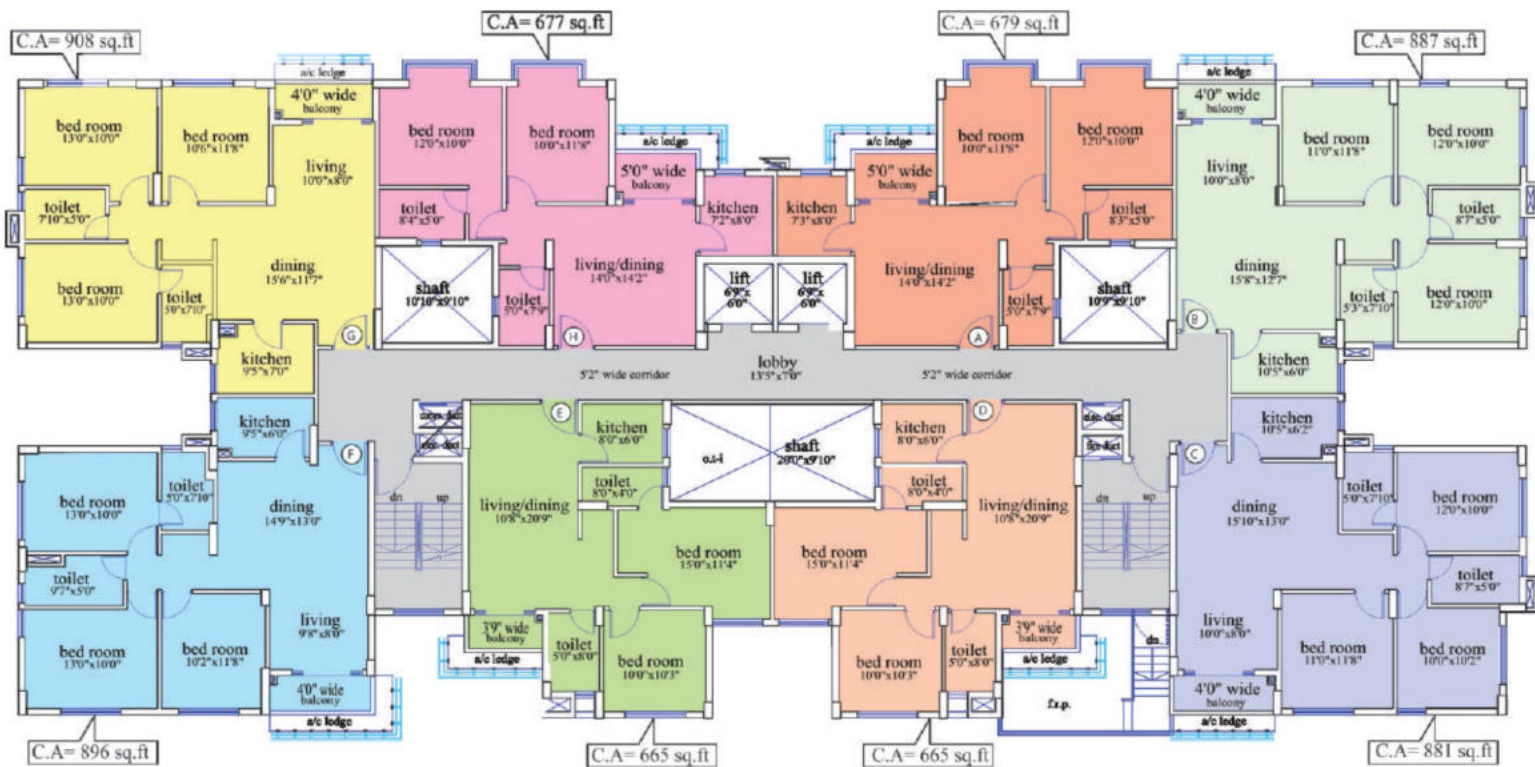

Dimensions mentioned are tentative, physical may vary.

Block 14 | Typical floor plan

TYPE	CARPET AREA	BALCONY AREA	BUILT-UP AREA
A	813	35	925
B	866	43	994
C	873	50	1002
D	662	22	753
E	662	24	755
F	863	36	978
G	905	45	1032
H	814	35	925



Dimensions mentioned are tentative, physical may vary.

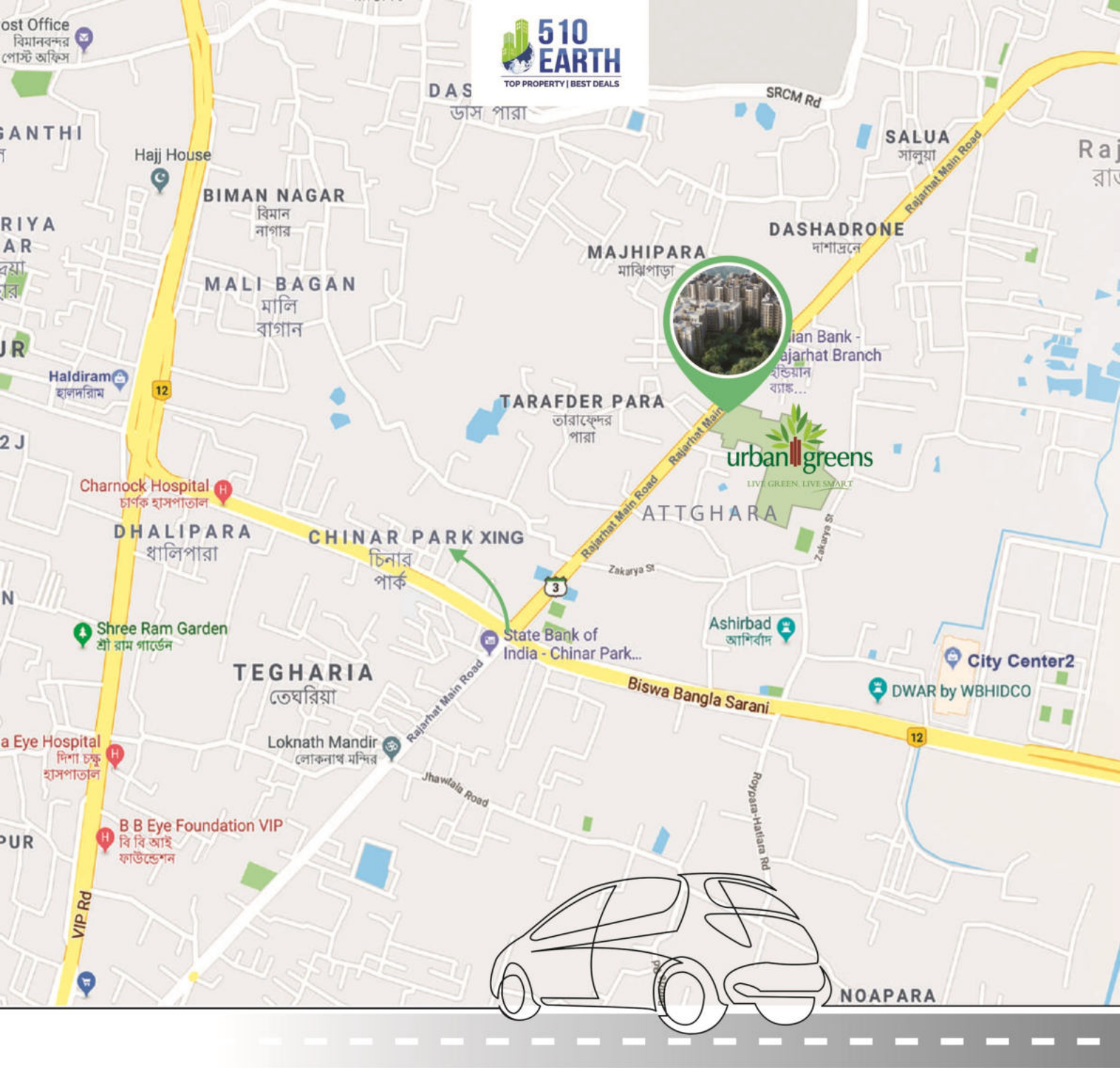

KEY DISTANCES 🚗 Major Arterial Road 0.5 km 🚗 City centre II 1.5 km 🚗 Airport 3.5 km 🚗 Haldiram's 1.5 km

This brochure is conceptually a marketing material for the Project URBAN GREENS. Phase-I of this project has been constructed and completed. Construction of Phase-IIA is in Progress & Phase-IIB is proposed to be constructed / marketed in near future. Buyers of the respective phases are advised to take note of all amenities and facilities available in their respective phase before buying a flat.

Stesalit Towers,
Office #7, 4th floor
Plot No E2-3, Block - EP & GP, Sector V,
Salt Lake, Kolkata - 700091
+91-9073338396

www.510earth.com

Disclaimer: This brochure is meant for marketing and advertising purpose only. The company reserves the right to alter the product details mentioned inside without any prior notice. All images are artist's impressions only