

PURTI

F L O W E R S



For a better tomorrow

a property by

PURTI
REALTY

Welcome to Purti Flowers



Purti Flowers, located in Jalkal (Maheshtala), Kolkata, is both a residential and commercial development of Purti Realty. It offers spacious and skillfully designed 2BHK, 3BHK and Penthouse apartments/ Flats. The project is well equipped with all the basic amenities to facilitate the needs of the residents. Purti Flowers not only boasts about 20,000 sqft of Residents Club it also has Spencer's (daily need store) within the complex. The apartment is in close proximity to Taratala Crossing, Dakgarh, Budge Budge, Khidderpore, Metiabruz and Base bridge.



Residential club



An Exclusive, fully Operational 20,000 sqft G+2 Residential club, well equipped with all the basic amenities to facilitate the needs of the residents.



Amenities

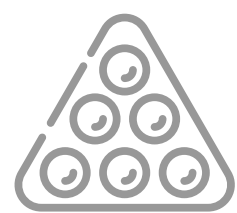

Pool



Chess



Steam
Sauna



Swimming
Pool



Community
Hall



Meditation
zone



Gym



Darts



Table Tennis

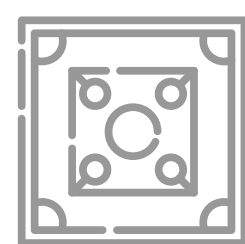

Carrom

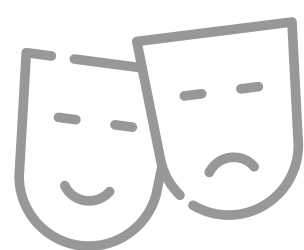

Mini
Theatre



Outdoor
Party area



Master Plan



Floor Plan

Lobelia 3rd floor



All measurements are in Sqft

Flat Nos.	Floors	Carpet Area	Balcony Carpet Area	Service Balcony Carpet Area	Terrace At 3rd Floor Built-up Area	Flat Built-up Area	Unit Area For Cam (50% terrace incl)
A	3RD	729.8	19.38	N.A	1457.37	831.9	2081
B	3RD	893.09	38.75	18.41	849.044	1047.3	1962
C	3RD	1066.07	51.24	19.48	1524.34	1263.9	2701
D	3RD	892.01	38.75	18.41	1381.779	1046.6	2317
E	3RD	729.58	19.38	N.A	975.113	831.5	1759
F	3RD	886.42	36.06	18.41	716.062	1038.7	1862
G	3RD	887.17	36.06	18.41	722.509	1037.8	1865
H	3RD	1079.52	51.77	19.48	1072.622	1281.9	2424
I	3RD	887.17	36.06	18.41	1216.789	1037.8	2195
J	3RD	885.23	36.06	18.41	849.911	1037.7	1950



Typical Floor Plan

Lobelia 4th to 13th floor

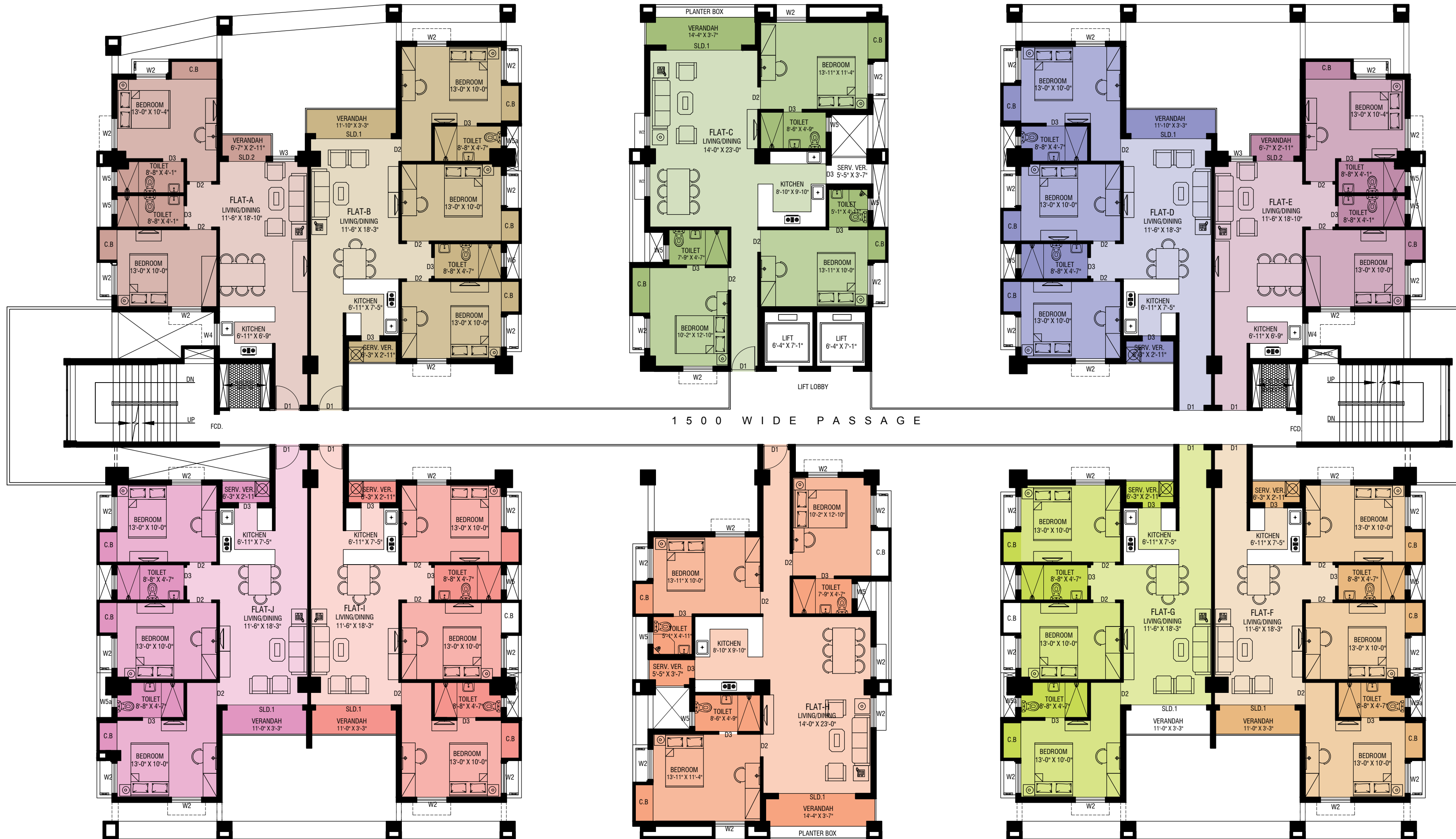

All measurements are in Sqft

Flat Nos.	Carpet Area	Balcony Carpet Area	Service Balcony Carpet Area	Flat Built-up Area	Unit Area For Cam
A	729.8	19.38	N.A	831.9	1109
B	893.09	38.75	18.41	1047.3	1397
C	1066.07	51.24	19.48	1263.9	1685
D	892.01	38.75	18.41	1046.6	1396
E	729.58	19.38	N.A	831.5	1109
F	886.42	36.06	18.41	1038.7	1385
G	887.17	36.06	18.41	1037.8	1384
H	1079.52	51.77	19.48	1281.9	1709
I	887.17	36.06	18.41	1037.8	1384
J	885.23	36.06	18.41	1037.7	1384





Within the premises



Mini-plex

Specifications

512 Residential Units 6 Towers
G+4, B+G+15, B+G+16, B+G+13 Storied



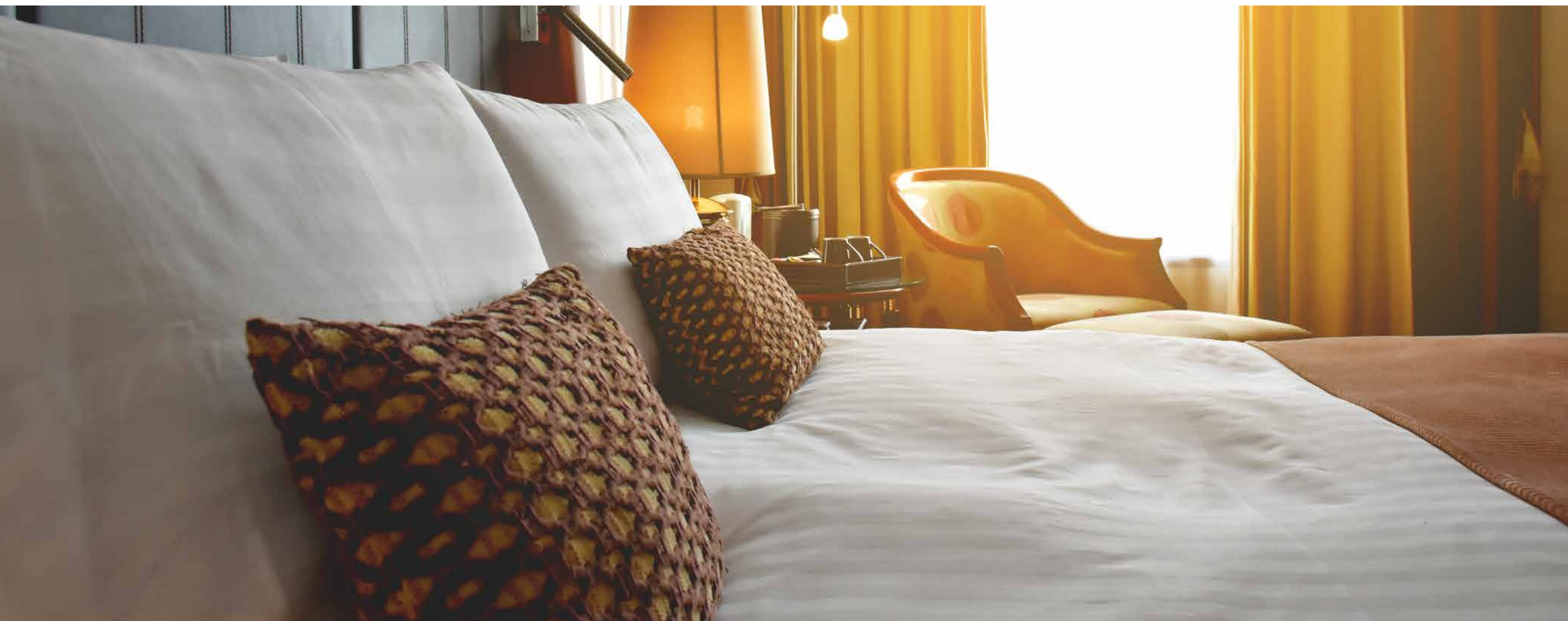





Flooring	Bedroom: Vitrified tiles Living / Dining Room: Vitrified tiles	Window	Aluminum windows
Kitchen	Black Granite Platform Flooring: Vitrified / Ceramic tiles Stainless steel sink Dado of ceramic tiles upto 2ft above the counter / platform	Electrical	Copper Concealed Wiring with Modular Switches
Toilet	Anti-skid ceramic tiles for flooring Wall tiles up to door height White sanitary ware of reputed make CP fittings of reputed make		
Door	Malaysian Sal-wood frame with flush doors		



Location Map



Location Advantages

-  Spencer's store within the Complex
-  900 Mtrs Kasturi Das Memorial Super Speciality Hospital
-  1.3 Kms George College of Management & Science
-  1.5 Kms Mount Litera Zee School
-  2.1 Kms Amrita Vidyalayam
-  6.3 Kms Taratala Crossing
-  6.6 Kms ESI Hospital
-  6.8 Kms Narayana School Maheshtala

Marketed by



CORPORATE OFFICE
Stesalit Towers,
Office #7, 4th floor
Plot No E2-3, Block - EP & GP, Sector V,
Salt Lake, Kolkata - 700091
Call us: 8336992745

